



23142 Arroyo Vista Rancho Santa Margarita, CA 92688

Tel: 949.888.8850 Fax: 949.888.8851

Website: www.storagerackengineering.com, email: al@storagerackengineering.com

Ali Abolhassani, P.E. President & Engineer of Record

## Drive In Rack Prelim Request

Date: \_\_\_\_\_

Requested By: \_\_\_\_\_

Project Name: \_\_\_\_\_

Company: \_\_\_\_\_

Project Address: \_\_\_\_\_

Phone: \_\_\_\_\_

Fax: \_\_\_\_\_

Please include any additional sketches or notes that would help illustrate the rack system better.

### Configuration

Configuration Name: \_\_\_\_\_

Number of Amrs \_\_\_\_\_

Pallet Weight \_\_\_\_\_

# of Pallets Deep \_\_\_\_\_

### Frame

Mfg or Type: \_\_\_\_\_

Column: \_\_\_\_\_

Backer?: \_\_\_\_\_ How High? \_\_\_\_\_

Bracing: Diagonals (as shown)  X-Braced

Diagonal Brace: \_\_\_\_\_ Horizontal Brace: \_\_\_\_\_

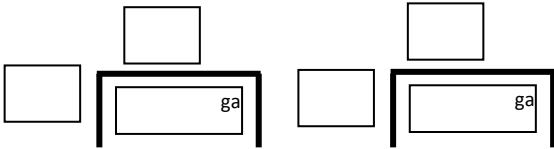
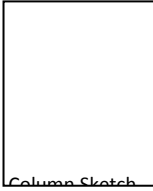

Sketch any other brace type here

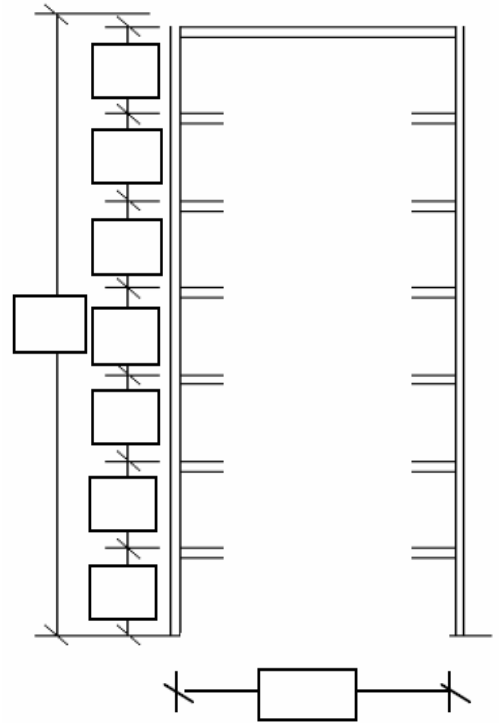

### Top Tie Beam

Mfg Type \_\_\_\_\_

Beam: \_\_\_\_\_

Connector Type: \_\_\_\_\_

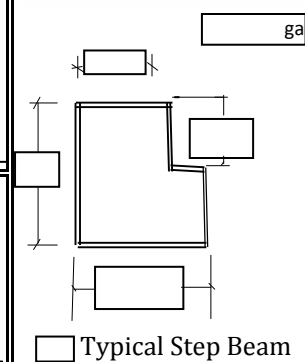

Sketch any other beam type here

### Base Plate

Down Aisle Width: \_\_\_\_\_ Thickness: \_\_\_\_\_

Cross Aisle Depth: \_\_\_\_\_ # Holes: \_\_\_\_\_

### Floor

Slab Thickness: \_\_\_\_\_ Soil Strength (psf): \_\_\_\_\_

Concrete Strength (psi): \_\_\_\_\_ Slab Reinforcing: \_\_\_\_\_

### Anchors

Indicate preferred anchor, if applicable.

### Notes